

GREYHOUND TORCHES



MADE IN USA



- 175 amp tig torch, close to the size of the TM17.
- A larger cable than the 150 amp so it “Holds Up” on the heavier jobs.
- Less weight and bulk than a 200 amp TM26 torch.
- Standard 10N series parts, as per TM17/18/26’s.
- Better life span than pushing a 150 amp torch @ 175 - 180 amps.
- Single piece or 3 pieces set up available.
- 3 pieces with “Yellow” short coil, close and precise feel.

Part No	Description
GH175F-12RR	3.8 m 1 Piece Torch Pack
GH175F-25RR	7.6 m 1 Piece Torch Pack
GH175FV-12RR	3.8 m 1 Piece Torch Pack W/ Valve
GH175FV-25RR	7.6 m 1 Piece Torch Pack W/ Valve

TIGMASTER®

TIGMASTER®

GH175F • GH175FV

175AMP AIR COOLED

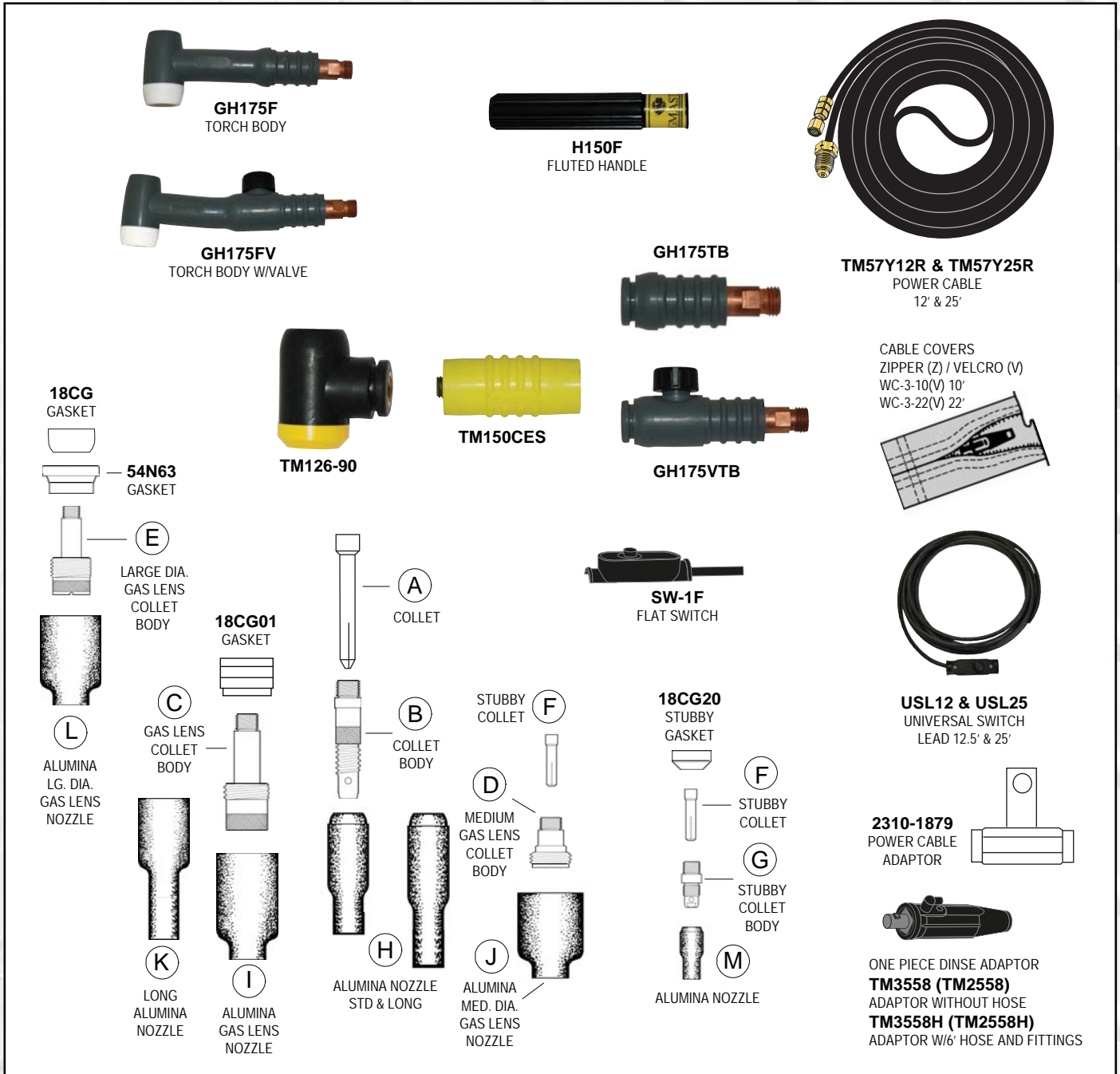

COLLETS • COLLET BODIES • GAS LENS

ITEM	ELECTRODE DIAMETER	.020 0.5 mm	.040 1.0 mm	1/16 1.6 mm	3/32 2.4 mm	1/8 3.2 mm	5/32 4.0 mm
A	COLLET	10N21	10N22	10N23	10N24	10N25	54N20
B	COLLET BODY	10N29	10N30	10N31	10N32	10N28	406488
C	GAS LENS	45V29	45V24	45V25	45V26	45V27	45V28
D	MED GAS LENS	-	-	45V25S	45V26S	45V27S	45V28S
E	LG DIA GAS LENS	45V0204		45V116	45V64	995795	45V63
F	STUBBY COLLET	10N21S	10N22S	10N23S	10N24S	10N25S	-
G	STUBBY COLLET BODY	17CB20					

GAS NOZZLES

ITEM	SIZE	4 6 mm	5 8 mm	6 10 mm	7 11 mm	8 12.5 mm	10 16 mm	12 19 mm	Short
H	Alumina STD	10N50	10N49	10N48	10N47	10N46	10N45	10N44	-
	Alumina Long	-	10N49L	10N48L	10N47L	-	-	-	-
I	Alumina Gas Lens	54N18	54N17	54N16	54N15	54N14	-	-	54N19
J	Med Alum Gas Lens	-	-	54N16SW	54N15SW	54N14SW	54N12SW	-	-
K	Long Alum Gas Lens	-	-	54N16L	54N15L	54N14L	-	-	-
L	Alumina LG Dia Gas Lens	-	-	-	57N75	57N74	53N88	53N87	53N89
M	Alumina Nozzle	13N08	13N09	13N10	13N11	13N12	13N13	-	-

ACCESSORY KIT AK-2 - With short cap, 3 Collets, 3 Collet Bodies, 3 Nozzles, 3 Tungsten Electrodes



INDEPENDENT WHOLESALE WELDING SUPPLY

Ph: 02 8834 2400 Fax: 02 8834 2498 Email: iwws@iwws.net Website: www.iwws.net