

# MIG-CART

MIG CART

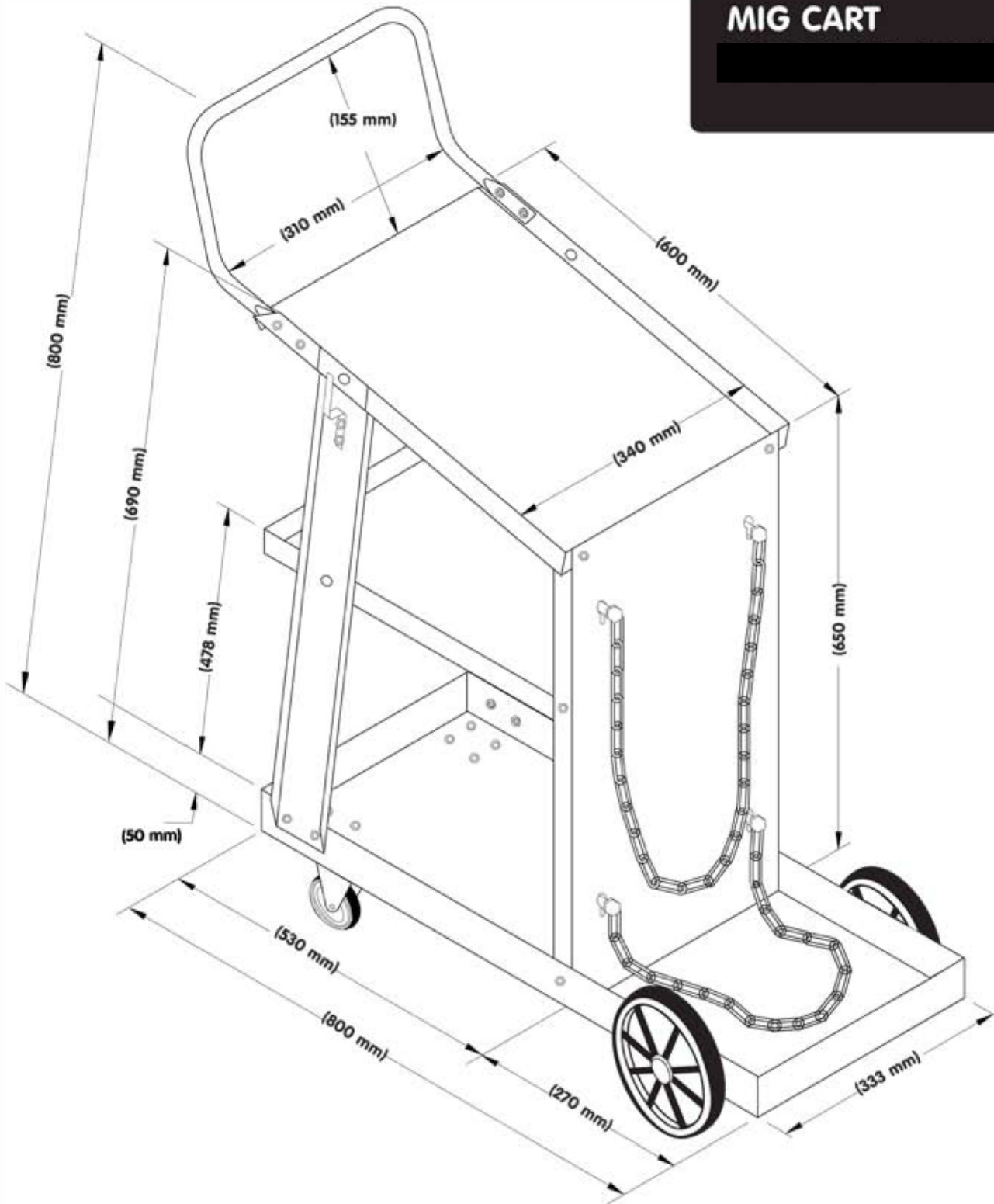

# MIG CART



Gross Wt. - 17.400 kG  
Net Wt. - 15.800 kG

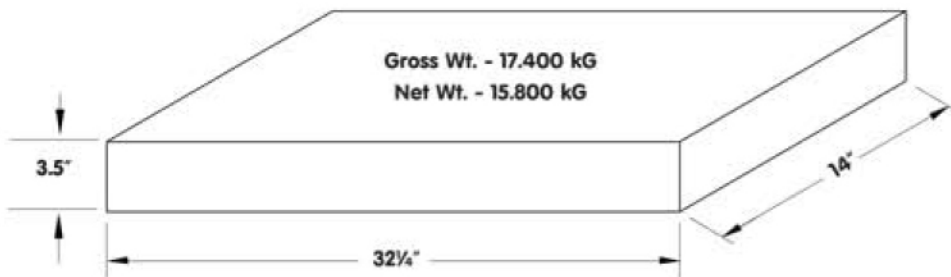

# MIG CART

Parts List			Component List		
Legend	Item	Qty.	No.	Item	Qty.
(A)	Bottom Shelf	1 pc.	(S)	Bolt, 6 mm x 13 mm	23 pcs.
(B)	Vertical Support	1 pc.	(T)	Bolt, 6 mm x 16 mm	12 pcs.
(C)	Top Shelf	1 pc.	(U)	Lock Nut - 6 mm	31 pcs.
(D)	Center Shelf	1 pc.	(V)	Hex Nut - 6 mm	4 pcs.
(E)	Side Support Rails	2 pcs.	(W)	Flat Washer - 6 mm	8 pcs.
(F)	Handle	1 pc.	(X)	Lock Washer - 6 mm	31 pcs.
(G)	Axle	1 pc.	(Y)	Flat Washer - 12 mm	4 pcs.
(H)	Castor Wheels	2 pcs.			
(I)	Wheels	2 pcs.			
(J)	Plastic End-Caps	2 pcs.			
(K)	Lynch Pins	2 pcs.			
(M)	Chains	2 pcs.			
(N)	Gun / Leads Hanger	2 pcs.			
-	Hex Wrench (6 mm)	1 pc.			
-	Allen Key (4 mm)	1 pc.			



HEX  
WRENCH  
(6 mm)

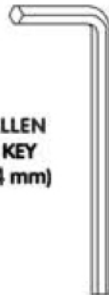

ALLEN  
KEY  
(4 mm)

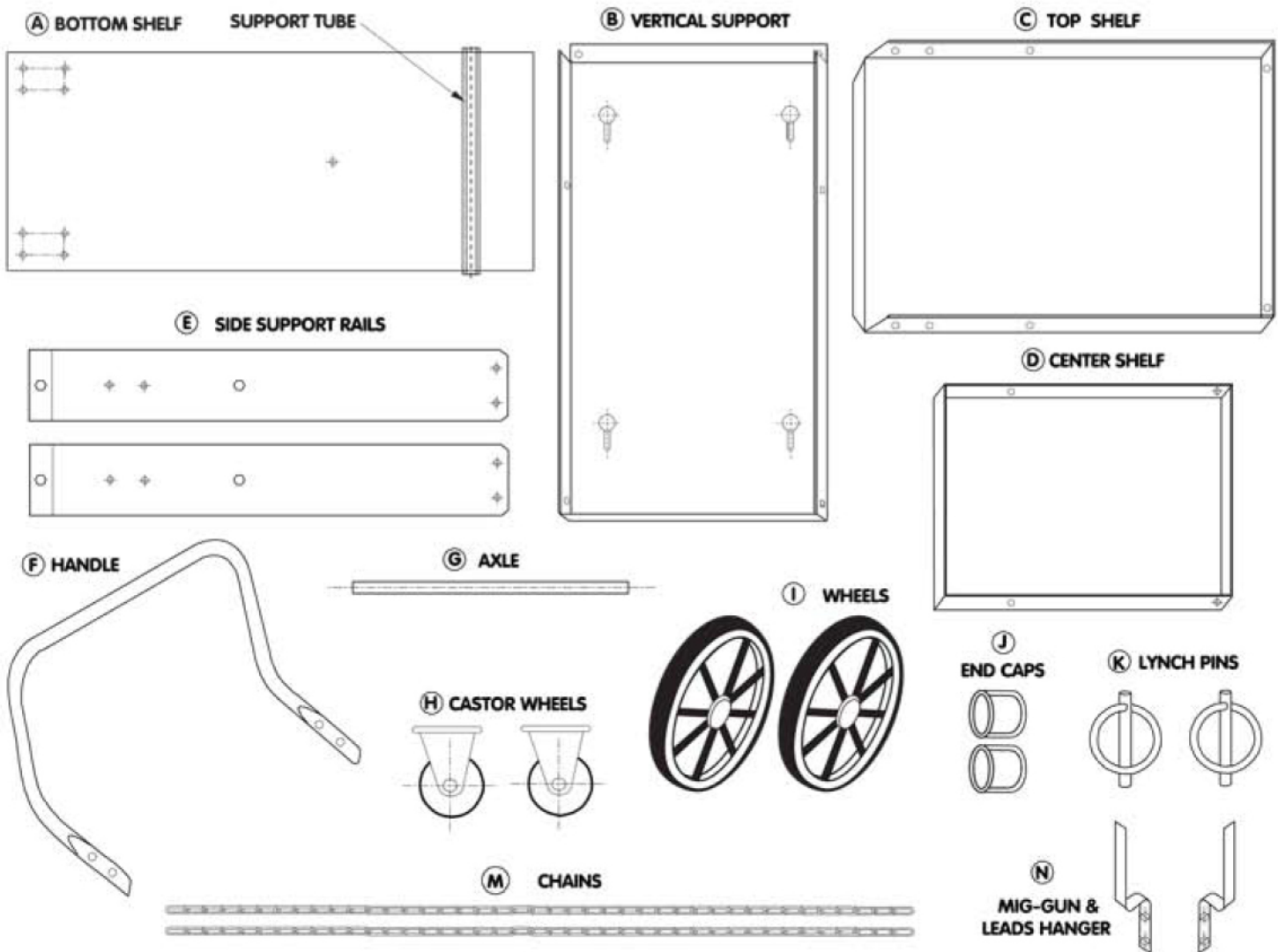
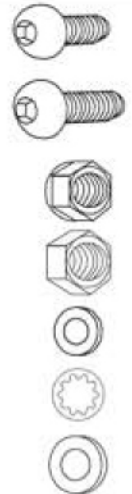

# MIG CART

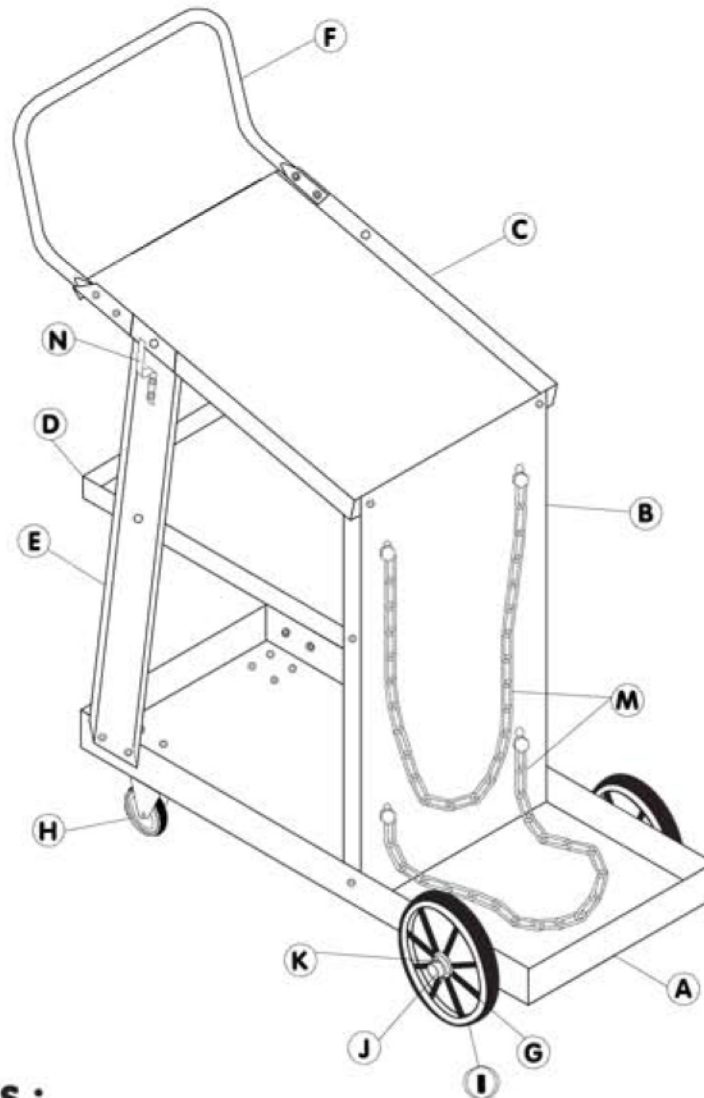

## Assembly Instructions :

- Step 1**
- Assemble two Castor Wheels (H) to the Bottom Shelf (A) using 8 Bolts, 6 mm x 13 mm (S), Lock Washers (X) and Lock Nuts (U)
  - Slide Axle (G) through support tube on bottom of the Shelf (A) Insert Flat Washers (Y) on each end of the Axle
  - Insert Wheels (I) onto Axle, then add another Flat Washer (X) and, thereafter, insert Lynch Pins (K)
  - Finally add Plastic End-Cap (J) on both ends of Axle
- Step 2**
- Attach Vertical Support (B) to the Bottom Shelf (A) using Bolts 6 mm x 13 mm (S), Lock Washers (X) and Lock Nuts (U)
  - Hand tighten all the Bolts & Nuts at this stage, to be fully tightened later
- Step 3**
- Attach the MIG / Tig Gun Leads Hanger (N) upward and facing outward on each Side Support Rail using 2 Bolts 6 mm x 16 mm (S), Lock Washers (X) and Lock Nuts (U).
  - Fasten Side-support Rails (E) to the Bottom Shelf using Bolts 6 mm x 13 mm (S), Lock Washers (X) and Lock Nuts (U)
  - Attach the Center Shelf (D) with Flanges facing upwards. Start by fastening Rear holes first and then the side holes using Bolts 6 mm x 13 mm (S), Lock Washers (X) and Lock Nuts (U)
- Step 4** Fasten the Top Shelf (C) using the same procedure as attaching the Center Shelf (D), as shown in **Step 3 (iii)**
- Step 5** Fit Handle (F) using 4 Bolts 6 mm x 16 mm (T), Lock Washers (X) and Lock Nuts (U), to the Top Shelf (C)
- Step 6** Tighten all the Bolts securely with the Wrench, if left loose earlier
- Step 7** Attach both the Chains using 4 Bolts 6 mm x 16 mm (T), Flat Washers (W) and Hex Nuts (V), to the Vertical Support (B) in the eyelets provided. Tighten the Bolts securely with the Wrench

**The Mig Cart is now ready for use !**

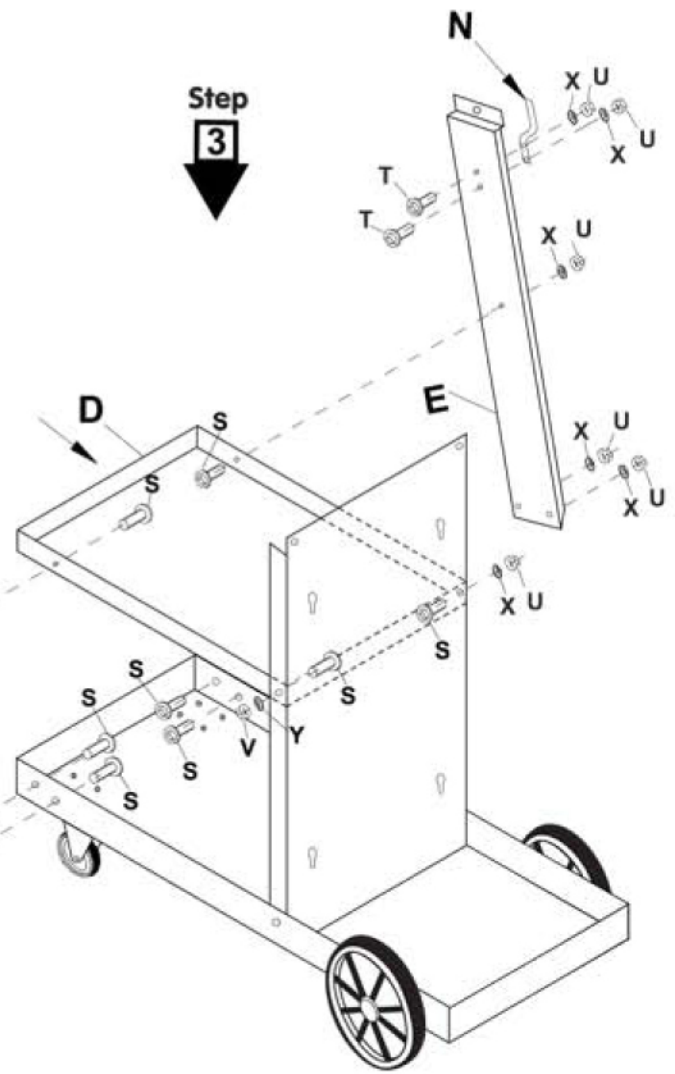
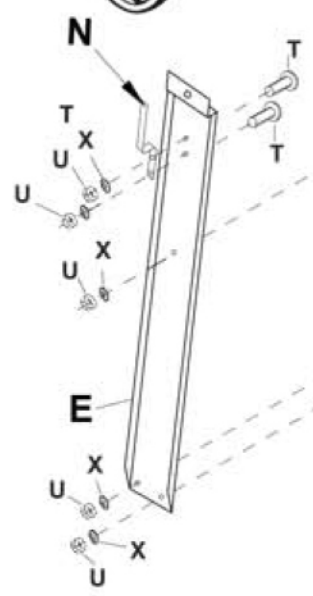
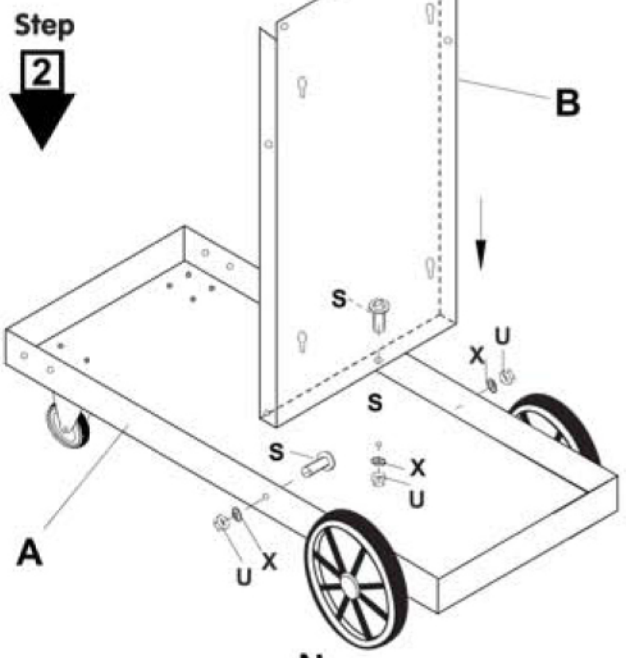
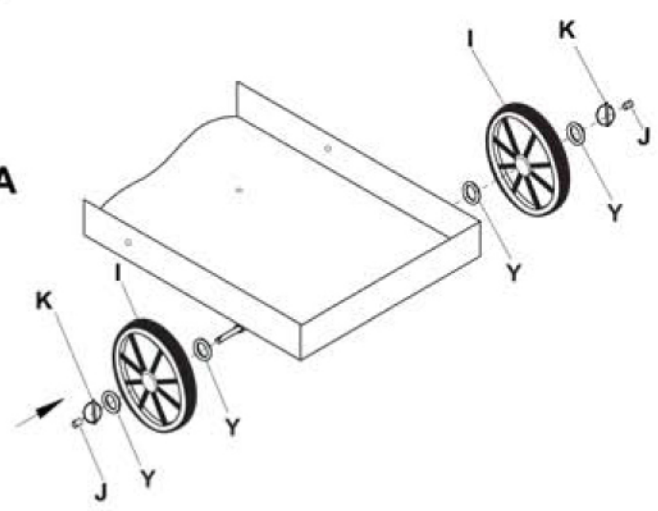
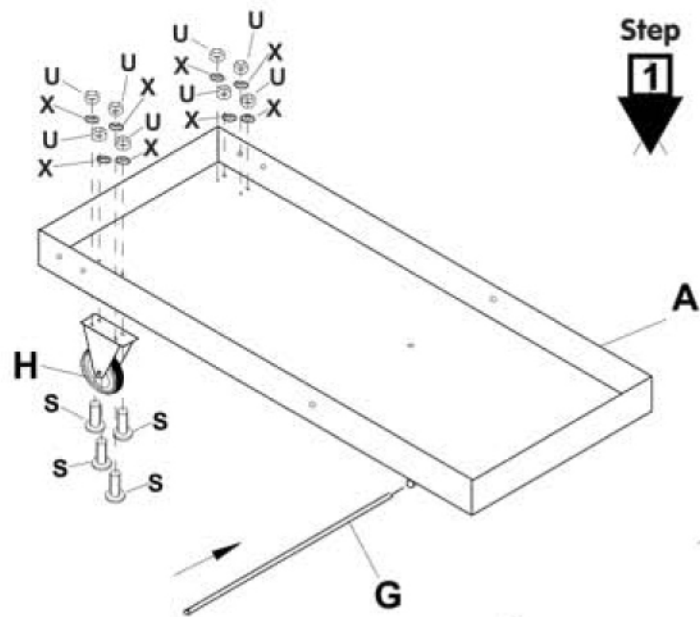

Step 4

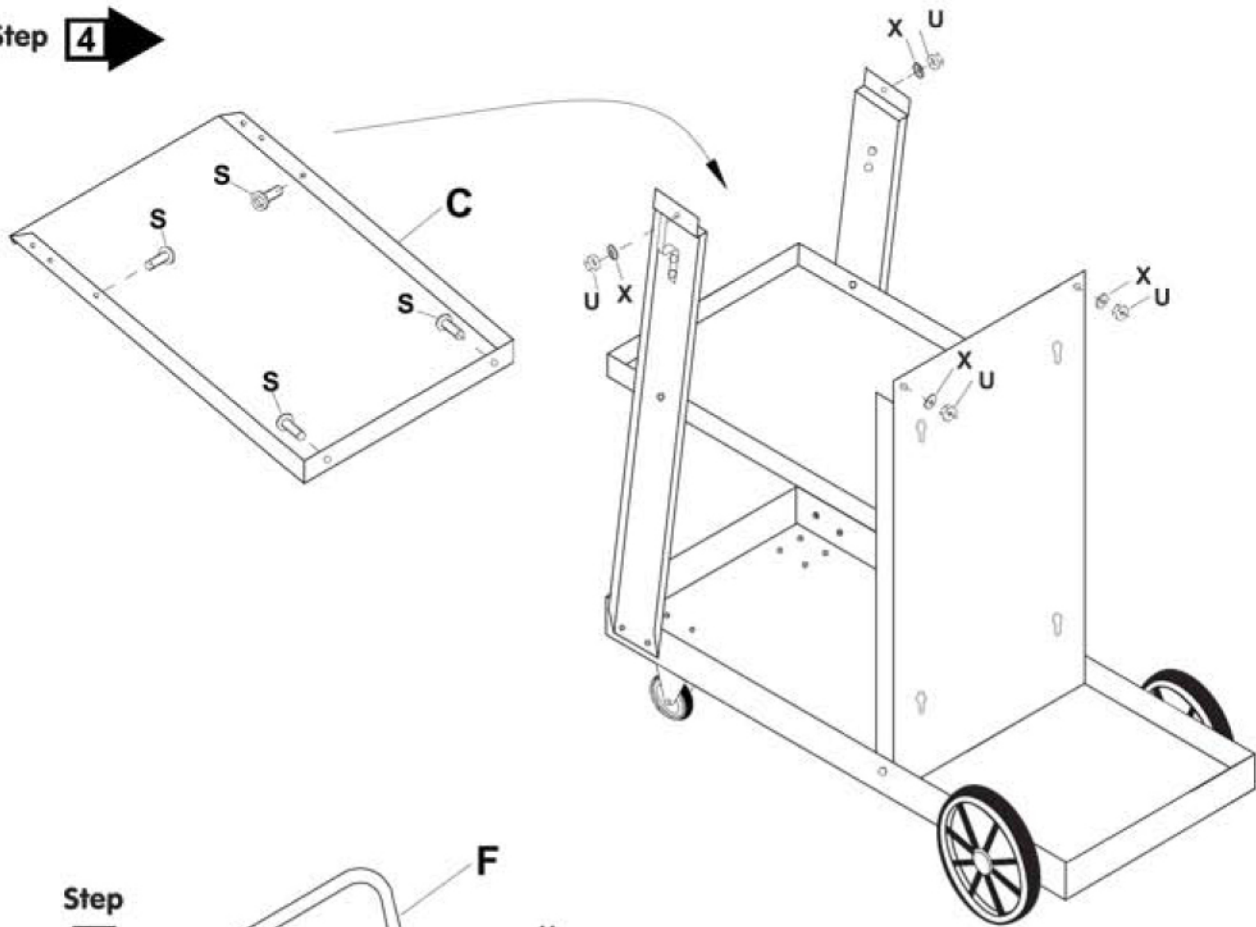

Step 5

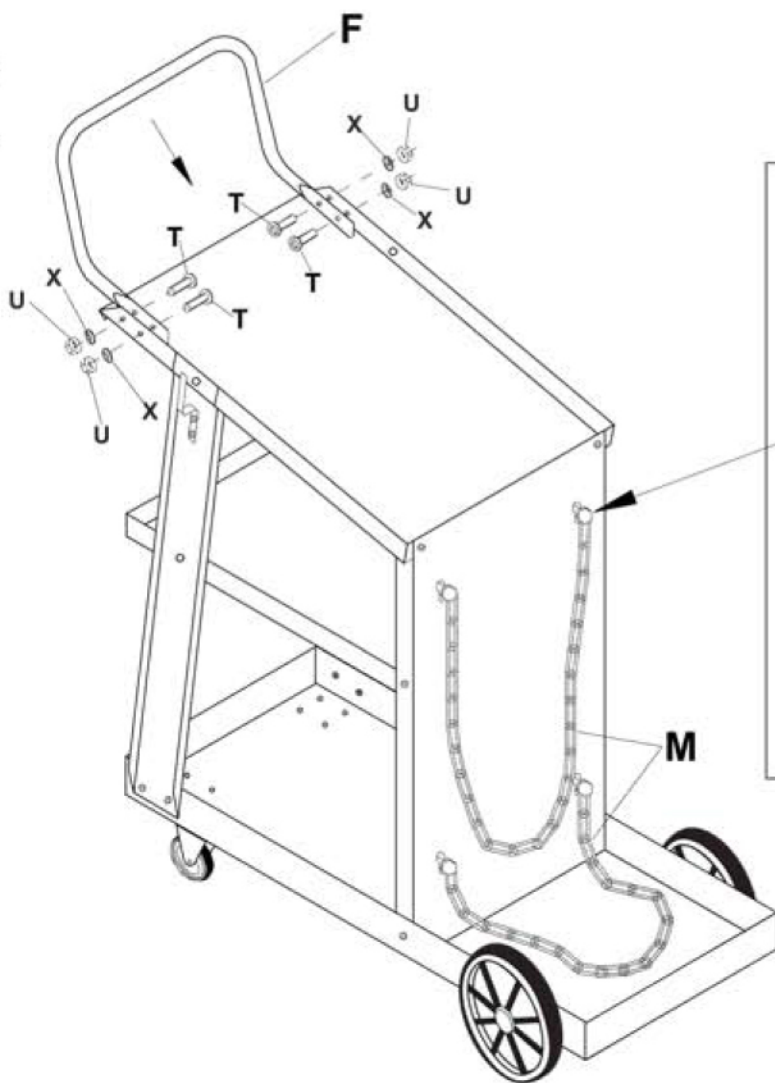

Step

6

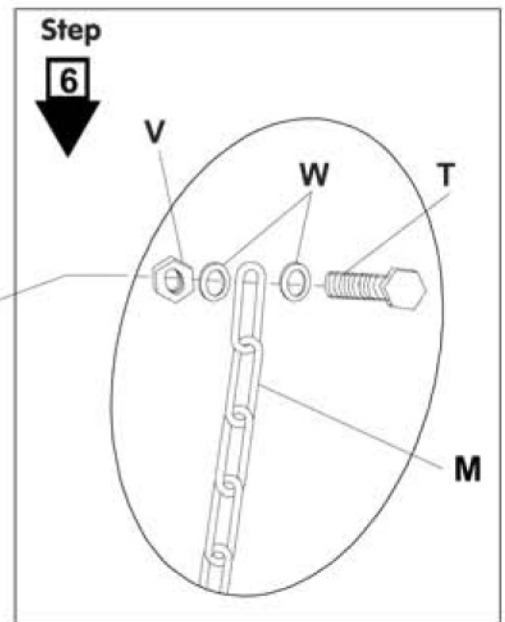



**SAFETY FIRST ! FOR YOUR OWN PROTECTION READ, UNDERSTAND AND OBSERVE THESE SAFETY TIPS AND ALL INSTRUCTIONS BEFORE USING THIS PRODUCT!**

- Do not use Mig-cart for the purpose it is not intended for.
- Always wear appropriate protective clothing and equipment. Do not wear loose clothing or jewelry. They can be caught in moving parts.
- Stay alert. Watch what you are doing. Use common sense. Do not operate when you are tired or under the influence of any medications. Be alert at all times, especially, during repetitive, monotonous operations.
- Do not over-reach. Keep proper footing and balance at all times.
- Keep visitors away. All visitors should be kept away from work area. Do not let visitors operate Mig-cart. Childproof the Mig-cart and work area. When not in use, the Mig-cart should be stored in locked-up place.
- Before using, make sure all fasteners are tight and unit is assembled as per the attached instructions. Carefully check for any damaged parts before use to determine that the Mig-cart will operate properly and perform its intended function. Check for alignment of moving parts, binding of moving parts, breakage of parts, mounting, and any other conditions that may affect its operation. Any part that is damaged should be properly repaired or replaced by an authorized service center.
- Maintain Mig-cart with care. Do not attempt to repair or disassemble the equipment while the Mig-cart is in use. Inspect Mig-cart periodically and if the Mig-cart or any of its parts are damaged - have it repaired by an authorized service facility. Always keep your Mig-cart Inspected and replace immediately, if damaged or worn.
- Do not alter or modify any part of this equipment. Mig-cart must only be repaired by qualified technicians.
- Always chain the Compressed Gas Cylinder securely with the chain provided.
- Never weld to the Compressed Gas Cylinder or the Mig-cart.
- Always use Mig-cart on level surface. Never park the Mig-cart on an inclined surface. It may roll away and tip, causing damage. Compressed Gas Cylinder is extremely dangerous if it tips over.
- Always move the Mig-cart by pushing or pulling on the Mig-cart. Never pull the Mig-cart around by the torch or work leads since the Mig-cart might trip. Never use handle extensions to increase leverage.
- Failure to heed these Warnings may result in personal fatal injury or property damage.